

MODEL  
**beltorque™**  
BT-RT or BT-ST

# High-Speed Belt *fascinating tops* Retorquer



The beltorque™ is a unique continuous-motion, high-speed retorquer that reapplies cap torque after induction sealing.



- Repetitive and stable process
- Single control for torque adjustment
- Synchronized technology tightens cap with belts causing no damage to cap
- Five minute changeover, no tools, no change parts
- Speeds up to 300 units per minute



A Century of Packaging Expertise

# Model beltorque™ High-Speed Belt Retorquer

## Technical Specifications

### Standard Features

- Stainless steel chassis
- Superior stability of the container during the cap tightening process
- Quick and simple torque adjustments
- One station to tighten cap
- All routine adjustments are scaled with no tools
- Validation of equipment is simplified
- Emergency button
- Polycarbonate front guard with keyed interlock
- Adaptable on 36" high conveyor
- 3/4" hp AC motor
- Speeds up to 300 units per minute

### Available Options

- One station to tighten cap (Model BT-RT)
- Two stations for screwing and tightening (Model BT-ST)
- Precision reading of applied torque
- HMI control panel
- Reject table
- Light tower
- Double belt assembly

### Air & Electrical Requirements

- Power supply: 220VAC, 1 phase, 50-60 Hz, 8A
- Air supply: 80 PSIG, 0.5 SCFM

### Cap & Container Criteria

- Cap diameter: from 0.5" to 5" (12 to 127mm)
- Container height: 2" to 12" (50 to 305mm)
- Container diameter: Minimum of 0.5" (12mm)  
Maximum of 7" (175mm)
- Runs on round, oval, square and rectangular containers

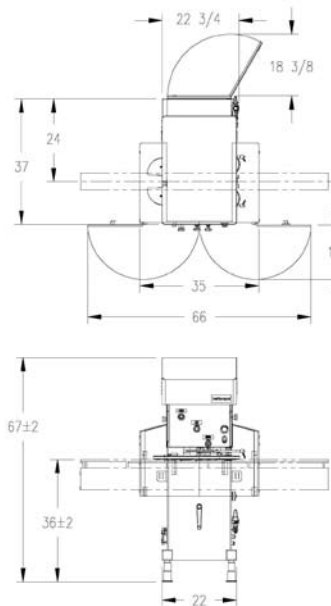

### Floor Plan

Dimensions shown are for basic machines and may vary depending on options. In view of our policy of continuing research and product improvement, actual specifications may vary from those shown. Please consult with an NJM Packaging representative regarding your specific requirements.

All NJM Packaging equipment is covered by a one year warranty on parts. A comprehensive nationwide service, parts, and sales support program is available for the life of your equipment. A customized Preventative Maintenance Program for this equipment is also available.

Contact our Customer Service Department at (603) 448-3940 for more information.

This equipment can be purchased separately or as part of a fully integrated packaging line. Contact your sales representative for full details on other packaging equipment and complete turnkey line integration services.

Protected by one or more U.S. and foreign patents.

Authorized NJM Packaging Sales Representative



A Century of Packaging Expertise

**USA** 56 Etna Road  
Lebanon, NH 03766 USA  
**1-800-432-2990**

**CANADA** 5600 Kieran, Montreal QC  
Canada H4S 2B5  
**1-800-811-6990**  
**www.njmpackaging.com**

Copyright © 2011 NJM Packaging

